

# NARRATIVE & DRAWINGS



## **Plan and Schedule of Operation for the Frederick Douglass Memorial Bridge**

South Capitol Bridgebuilders (SCB) is the design builder selected by the District Department of Transportation (DDOT) to design and build the South Capitol Street Corridor Project, including the full replacement of the Frederick Douglass Memorial Bridge (FDMB). The proposed schedule and major milestones for the FDMB construction includes:

- Begin Temporary Trestle Installation: February/June 2018 (dependent on permit modification). This will include partial removal of the existing bridge center fender, where in conflict.
- Begin Bridge Pile Driving/Bridge Construction: February 2018/July 2018 (pending permit modification for pile driving during time of year restriction for fish protection).
- Complete Temporary Trestle Installation: September 2018
- Complete Production Pile Driving: October 2018
- Begin Temporary Trestle Removal: April 2020
- Complete Trestle Removal/ Major Bridge Construction: November 2020
- Switch Traffic from old bridge to new bridge: May 2021
- Begin Old Bridge Demolition: May 2021
- Complete Demolition: December 2021

Plans are attached which show the proposed new FDMB and the temporary trestles proposed to facilitate construction of the new bridge. SCB's design has two in-river piers and the design offers a 492' horizontal opening including the entire 400' Federal Navigation channel. The SCB bridge design also exceeds the required vertical clearance of 42 vertical feet.

Regarding temporary construction elements, one trestle will extend from the west bank of the Anacostia and the other trestle will extend from the east bank of the Anacostia, leaving the required 150' horizontal opening at the existing Federal Navigation channel during construction. The attached plans show how the different phases of the trestle during the construction process. Navigation lighting will be provided at the farthest channelward extent of the trestle and construction lighting will be used to illuminate the trestle landward.

Other pertinent information:

- No anchor lines are anticipated to be used during the construction of the trestle or new bridge. Barges will be spudded or moored outside of the 150' Federal navigation channel
- Due to the use of the trestles, very few barges will be needed to construct the new bridge.
- No scaffold or netting is anticipated
- General work hours are 7AM-7PM Monday through Saturday but large concrete placements and other rare major elements may require extended hours, which will be reviewed and approved/permitted by DCRA.

- SCB does not intend to regularly move equipment at night except during the winter when night time starts prior to 7PM or ends after 7AM.
- In general, the 150' navigation channel will be open during construction. SCB will request and advise USCG via Local Notice to Mariners when construction activities will effect marine traffic. SCB anticipates brief (1 -2 hours) closures of the channel during steel erection directly over the channel.
- The detailed demolition plan is still under development and will be submitted to USCG for review. The current demolition plan includes the use of barges and cofferdams. Crane barges will be properly lit and cofferdams will be installed to facilitate removal of in-river piers. Minor and brief navigation channel restrictions will be required in order to safely remove major elements of the old bridge directly above the Federal Navigation channel (such as steel girders).
- All barges will be properly lit at all times.
- Navigation channel lighting, as noted on the attached drawings, will be maintained on existing FDMB until demolition commences.
- Following completion of construction, an as-built survey will be provided to USCG, per USCG requirements.

REG	STATE	PROJECT
9	D.C.	F.A.P. NO. 8888(286)

# Temporary Lighting and Navigation Channel for Frederick Douglas Memorial Bridge Replacement

Plan View

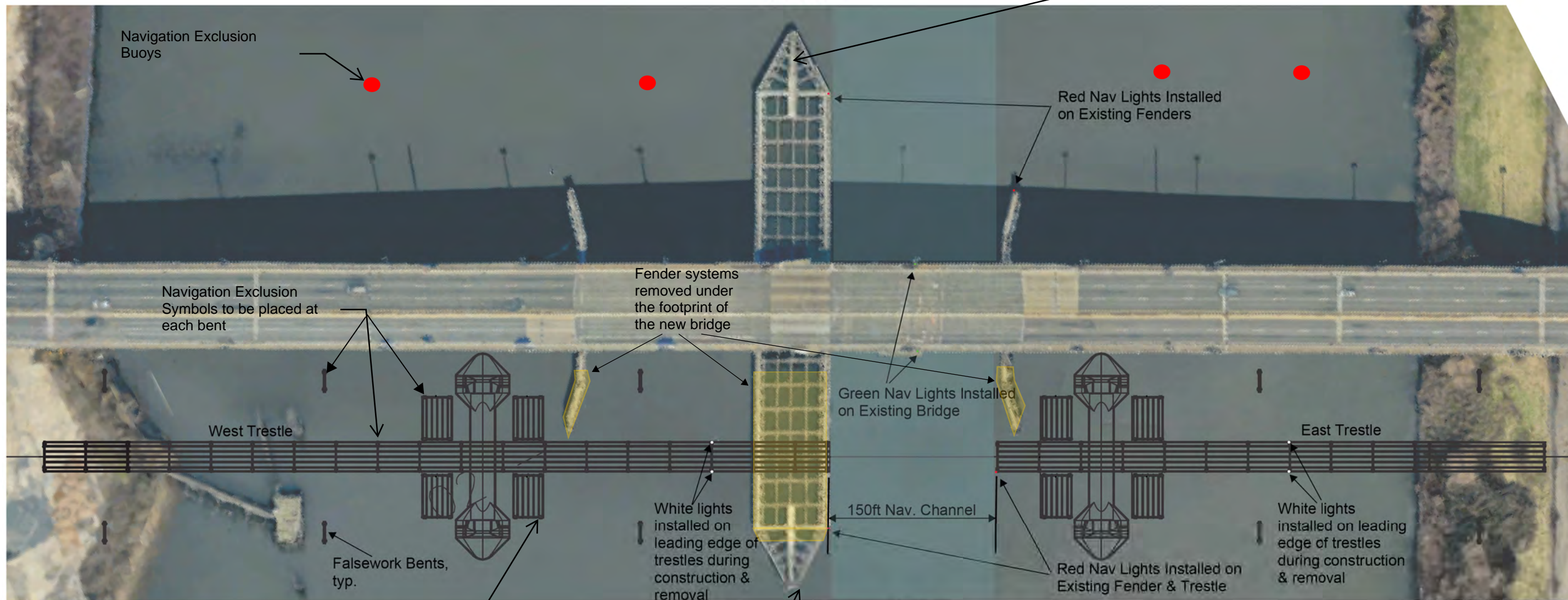

Information sign on fender  
"TWO WAY CHANNEL - STAY RIGHT"



**Exclusion**

A diamond shape with a cross means boats are prohibited from the area

2500lm LED white lights 10' o/c along trestle handrail (typ) See Detail Sheet

Information sign on fender  
"TWO WAY CHANNEL - STAY RIGHT"

**Notes:**

- Existing Nav lights will not be modified until the West Trestle reaches the existing Channels.
- West Trestle construction will start on the West bank and work towards the channel, East Trestle construction will start on the East bank and work towards the channel. Removal will begin at the channel and work towards the bank.
- Falsework bents will be installed after the trestle and removed prior to trestle removal.
- Navigation exclusion symbols will be placed on both the upstream and down sides of trestle and falsework bents. Buoys to be places as shown.



NO.	DESCRIPTION	NAME	DATE
REVISIONS			

D.C. DEPARTMENT OF TRANSPORTATION INFRASTRUCTURE PROJECT MANAGEMENT ADMINISTRATION PROJECT MANAGEMENT DIVISION	
SOUTH CAPITOL STREET CORRIDOR PHASE 1 PROJECT	PROJECT ENG. _____ DESIGNED BY _____ CHECKED BY _____ DRAWN BY _____ PROJECT MGR. _____
FREDERICK DOUGLASS MEMORIAL BRIDGE <b>TEMPORARY STRUCTURES</b> <b>SHEET 1 OF 2</b>	DIVISION CHIEF _____ DATE _____ FILE _____ SHEET _____ OF _____

P:\Transportation\60319510 - South Capitol Street - FDMB\CADD\Permit Drawings\PERMIT2\PERMIT.dgn  
Monday, October 02, 2017 AT 04:24 PM  
songers

REG	STATE	PROJECT
9	D.C.	F.A.P. NO. 8888(286)

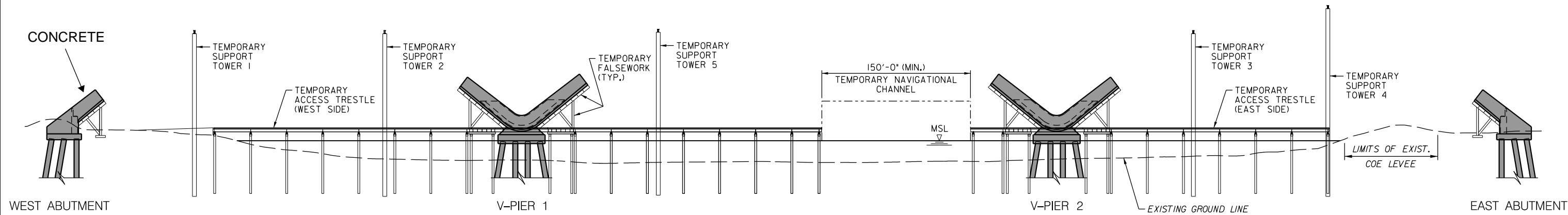

CONSTRUCTION SEQUENCE - PHASE A  
TRESTLE INSTALLATION

NOTES:

1. TRESTLE WILL BE INSTALLED FROM BOTH EAST AND WEST BANKS AS NOTED ON THE PLAN VIEW.
2. LIGHTING TO BE PER CONSTRUCTION PLAN VIEW NOTATIONS

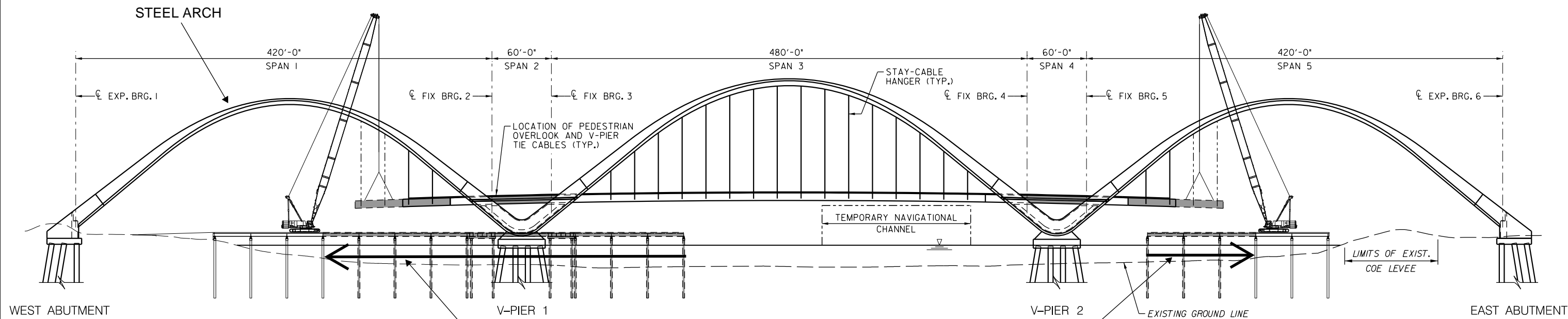

CONSTRUCTION SEQUENCE - PHASE B  
TRESTLE REMOVAL & BRIDGE CONSTRUCTION

Trestles removed as deck installation progresses

Trestles removed as deck installation progresses

NOTES:

1. NAVIGATION CHANNEL LIGHTING WILL BE MAINTAINED DURING BRIDGE CONSTRUCTION AS NOTED ON CONSTRUCTION PLAN VIEW DRAWINGS.
2. ONCE NEW BRIDGE IS COMPLETE, THE NAVIGATION CHANNEL WILL BE MODIFIED TO THE PERMANENT CONDITION

30% PLANS  
(NOT FOR CONSTRUCTION)



NO.	DESCRIPTION	NAME	DATE

BRIDGE: S-1 DRAWING NO: BR-SC02

D.C. DEPARTMENT OF TRANSPORTATION  
INFRASTRUCTURE PROJECT MANAGEMENT ADMINISTRATION  
PROJECT MANAGEMENT DIVISION

SOUTH CAPITOL STREET CORRIDOR  
PHASE 1 PROJECT

FREDERICK DOUGLASS MEMORIAL BRIDGE

**TEMPORARY STRUCTURES  
SHEET 2 OF 2**

PROJECT ENG. _____	DESIGNED BY _____
CHECKED BY _____	DRAWN BY _____
PROJECT MGR. _____	DIVISION CHIEF _____
DATE _____	FILE _____
SHEET _____	OF _____

P:\Transportation\6031910 - South Capitol Street\ FDMB\CADD\Final Design - these files are copies\BR-SC02.31950.dgn  
 Friday, September 29, 2017 AT 10:31 AM  
 sanger



Job Site String Light: For LED, 100 ft Cord Lg, 10 Lightheads, 8 in Overall Ht, 120V AC, 6.6 W Watt, Bulb Incl

Item # 599A902  
\$332.18 Each

Qty:

Product Specs

For Bulb Type:	LED
Maximum Height:	2.5 in
Brightness:	2,500 lm
Number of Lightheads:	10
Bulb Included:	Yes
Battery Operated:	No
Cord Length:	100 ft
Height:	8 in
Voltage:	120V AC
Wattage:	6.6 W
Lighthead Material:	Polycarbonate
Light Distribution:	Flood
Application:	Portable Lighting
Current:	0.55

2500lm LED Lights at 10' o/c full length of handrail

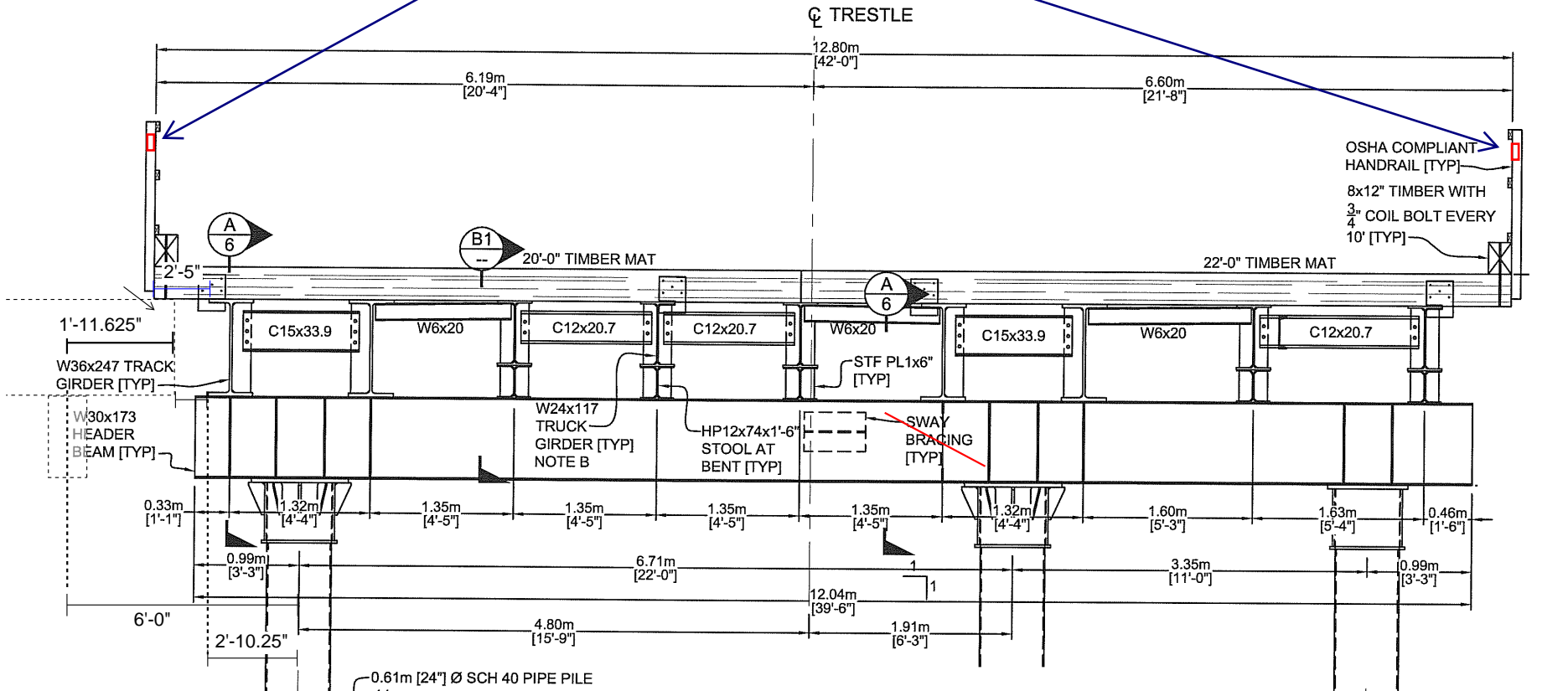

D.C. DEPARTMENT OF TRANSPORTATION INFRASTRUCTURE PROJECT MANAGEMENT ADMINISTRATION PROJECT MANAGEMENT DIVISION	
SOUTH CAPITOL STREET CORRIDOR PHASE 1 PROJECT	PROJECT ENG. _____ DESIGNED BY _____ CHECKED BY _____ DRAWN BY _____ PROJECT MGR. _____
FREDERICK DOUGLASS MEMORIAL BRIDGE	DMISION CHIEF _____
<b>Trestle Lighting Detail</b>	DATE _____ TITLE _____ SHEET _____ OF _____



NO.	DESCRIPTION	NAME	DATE